

PORT- FOLIO

CAROLYN SHEAN

Year 1:
project 1-5 (pg. 2-12)

Year 2:
project 6-8 (pg. 13-15)

About me (pg. 16)

Highschool Portfolio (pg. 17-19)

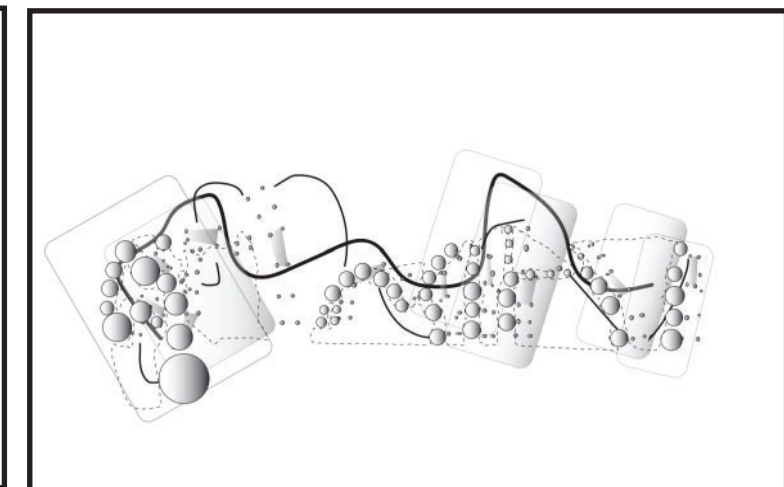
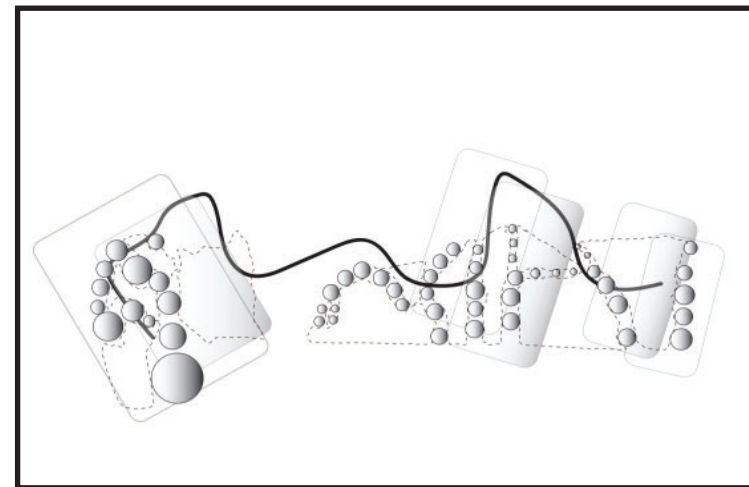
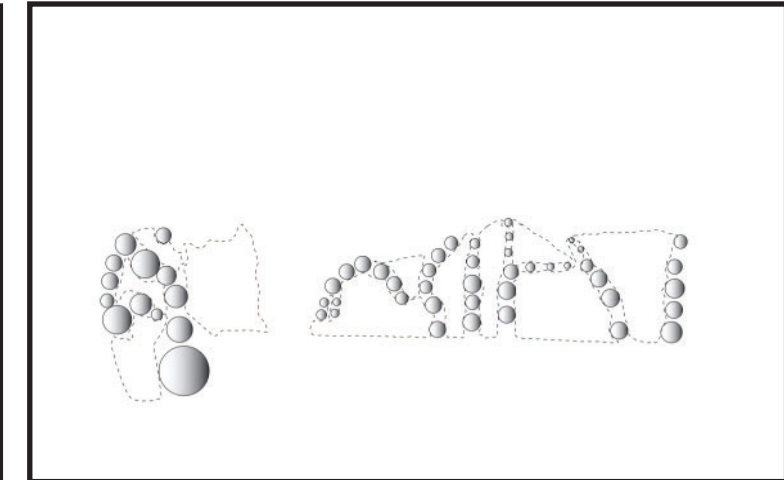
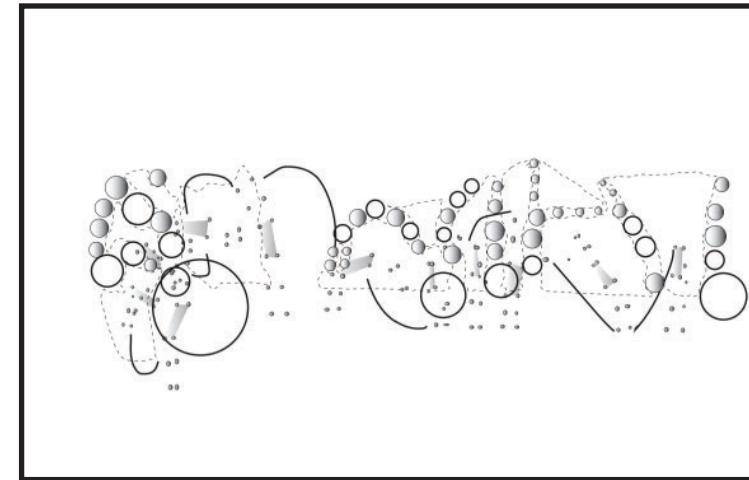

For project one, we experimented with different videos of bodies in motion and broke their motions down frame by frame. We then did layers of different shapes and designs in Illustrator to outline the parts of the frame by frame motion drawing. As we created different Illustrator drawings to highlight the important features of the motions, we then took the motions and make it into a unique 3D model seen above.

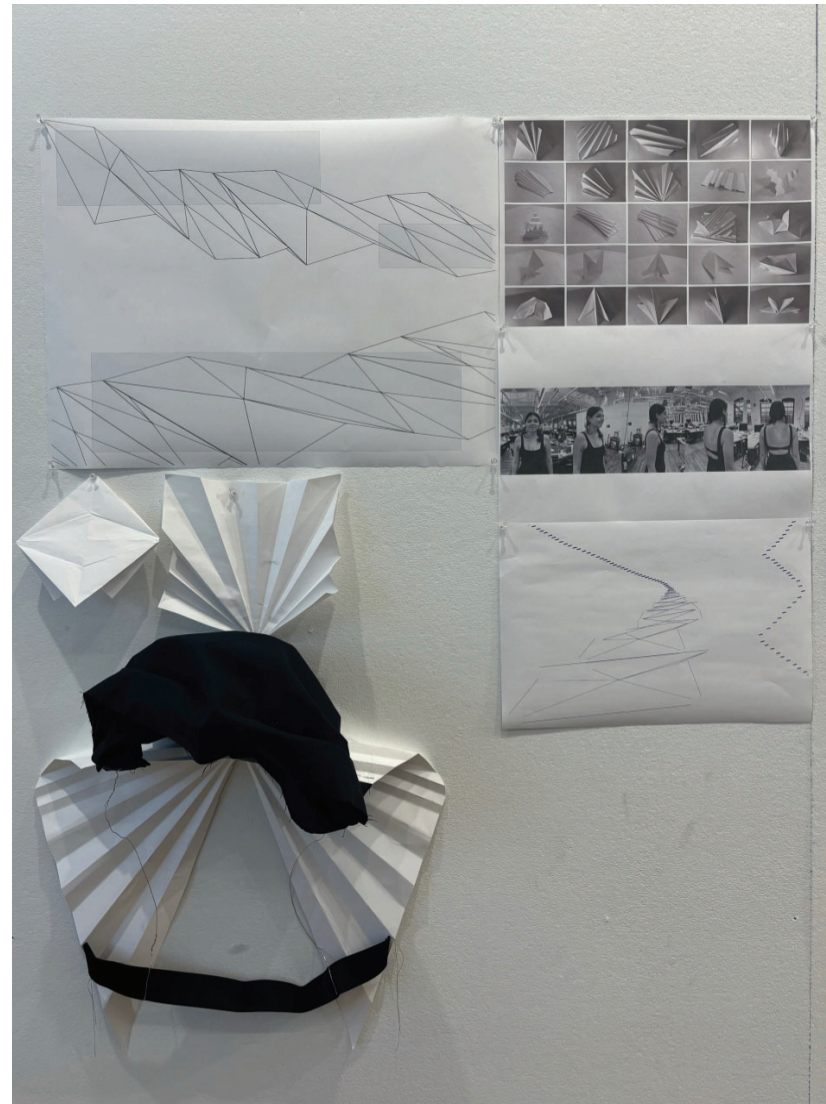

For project two, I focused on paper folding techniques to create a 3D paper model that enhances the body through a specific movement. I chose a winged hood design, where the motion involves reaching behind to grab the hood and place it on, accentuating the shoulder blades. I experimented with various folding techniques, viewing different creases and angles to utilize the design's aesthetics and movement. This technique shows the relationship between form and functional motion in wearable design.



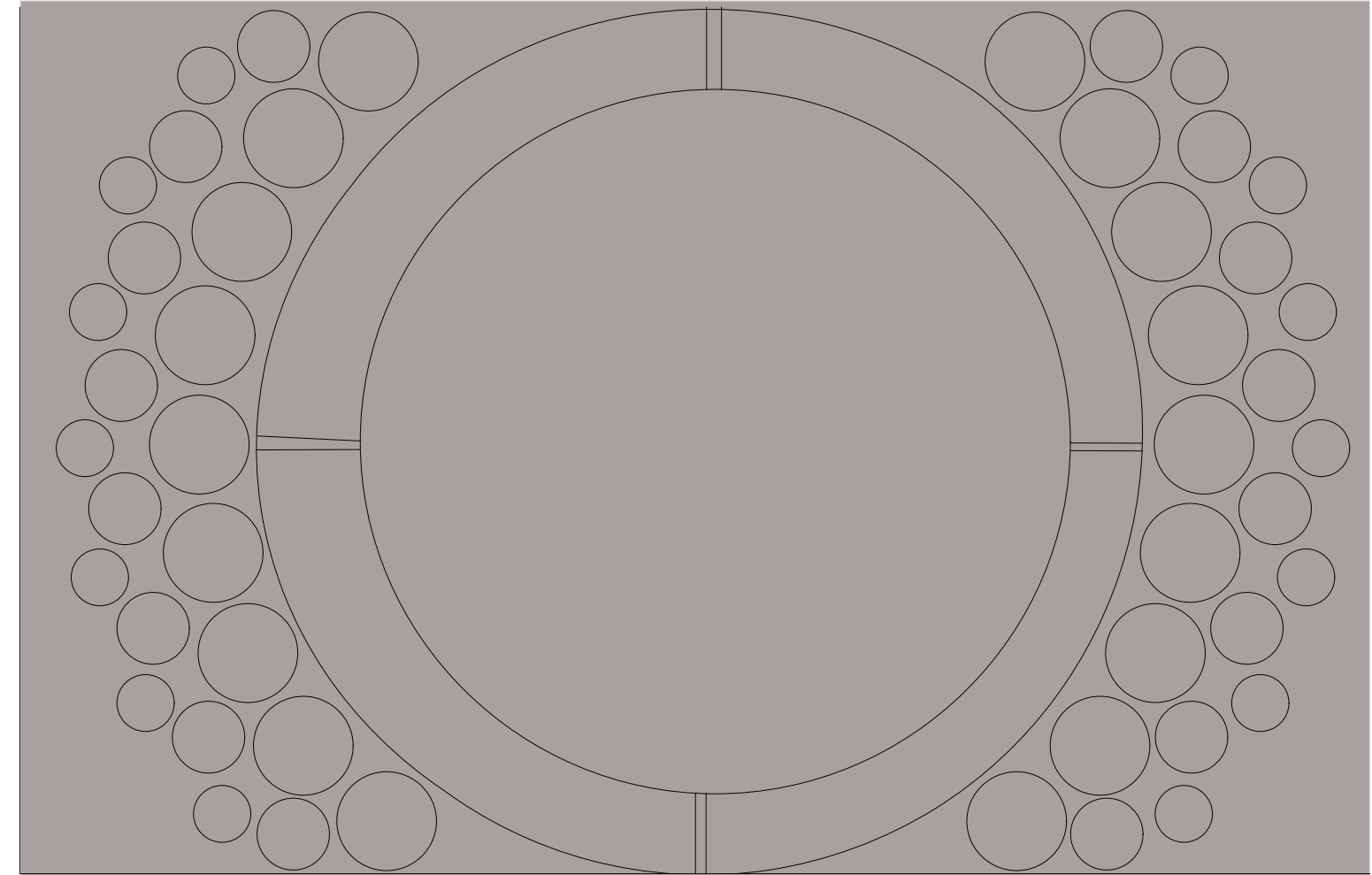
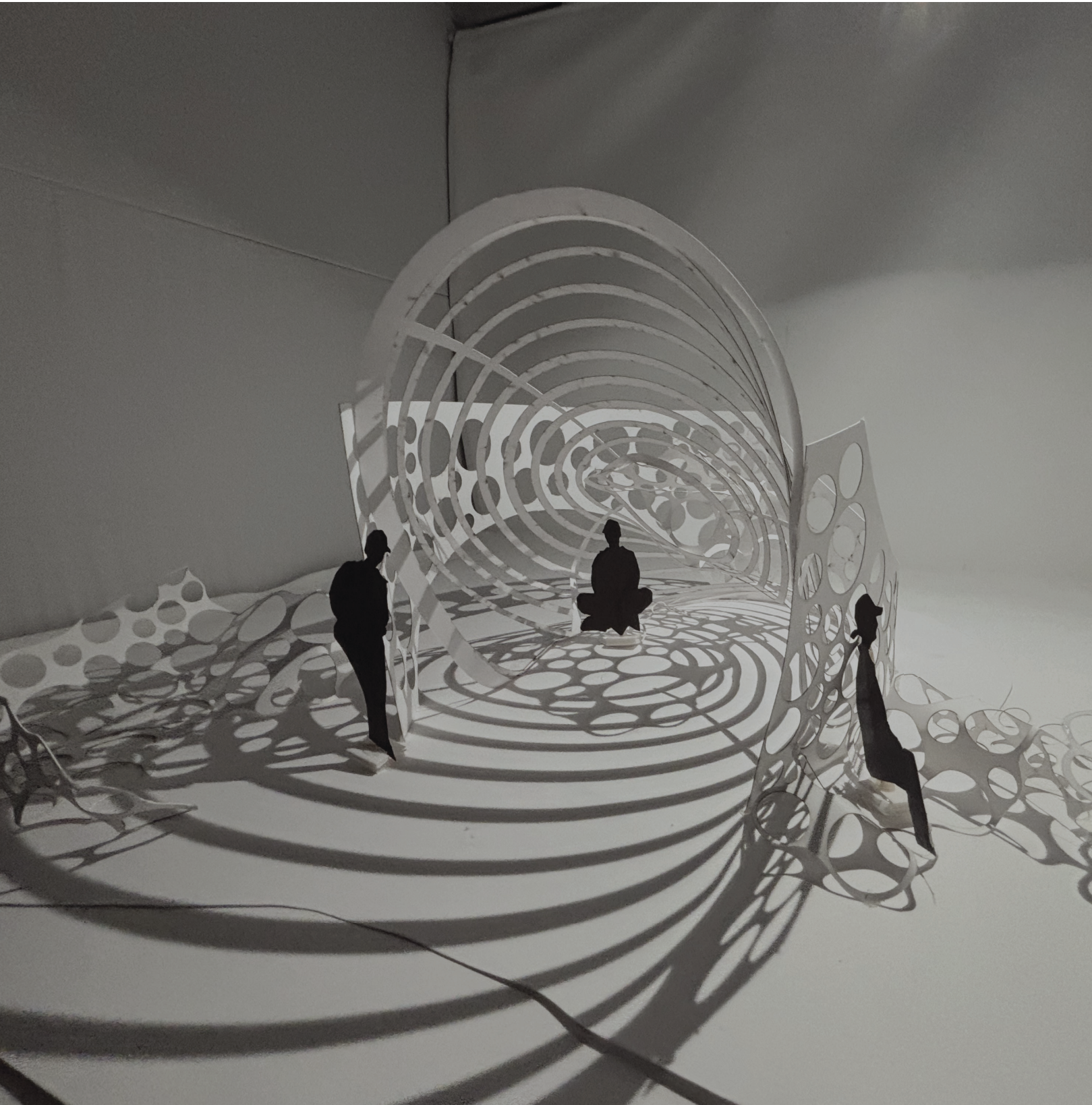

For project three, I elevated the concept of paper folding. Utilizing Rhino8, I designed an intricate pattern that could be laser-cut and molded into an interior space. I enhanced the design by allowing light to cast shadows through the circular and intertwined cutouts, resulting in a distinctive elongated shadow effect. The figures in the model provide a sense of scale, illustrating how tall the installation would be if constructed.

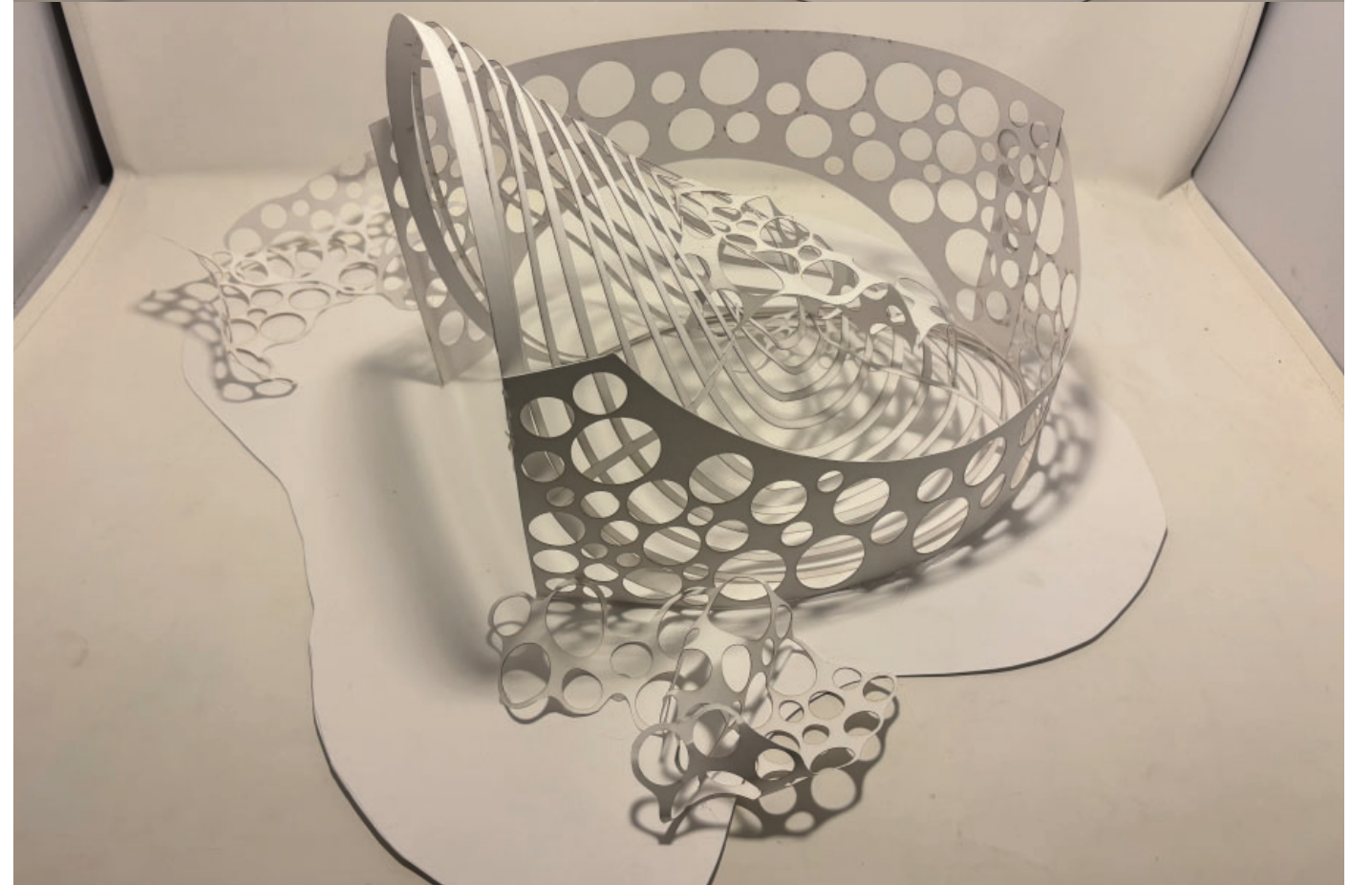
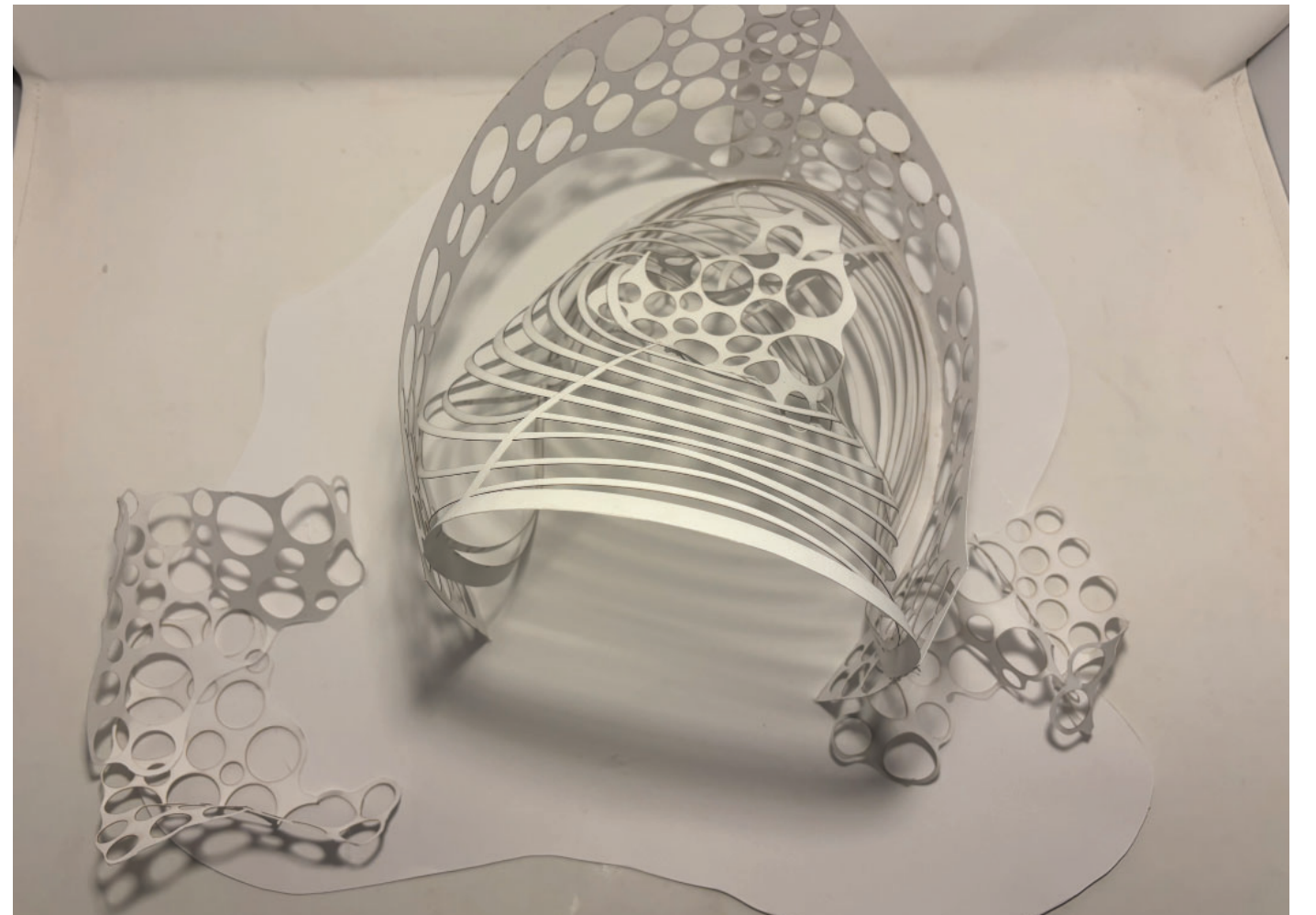

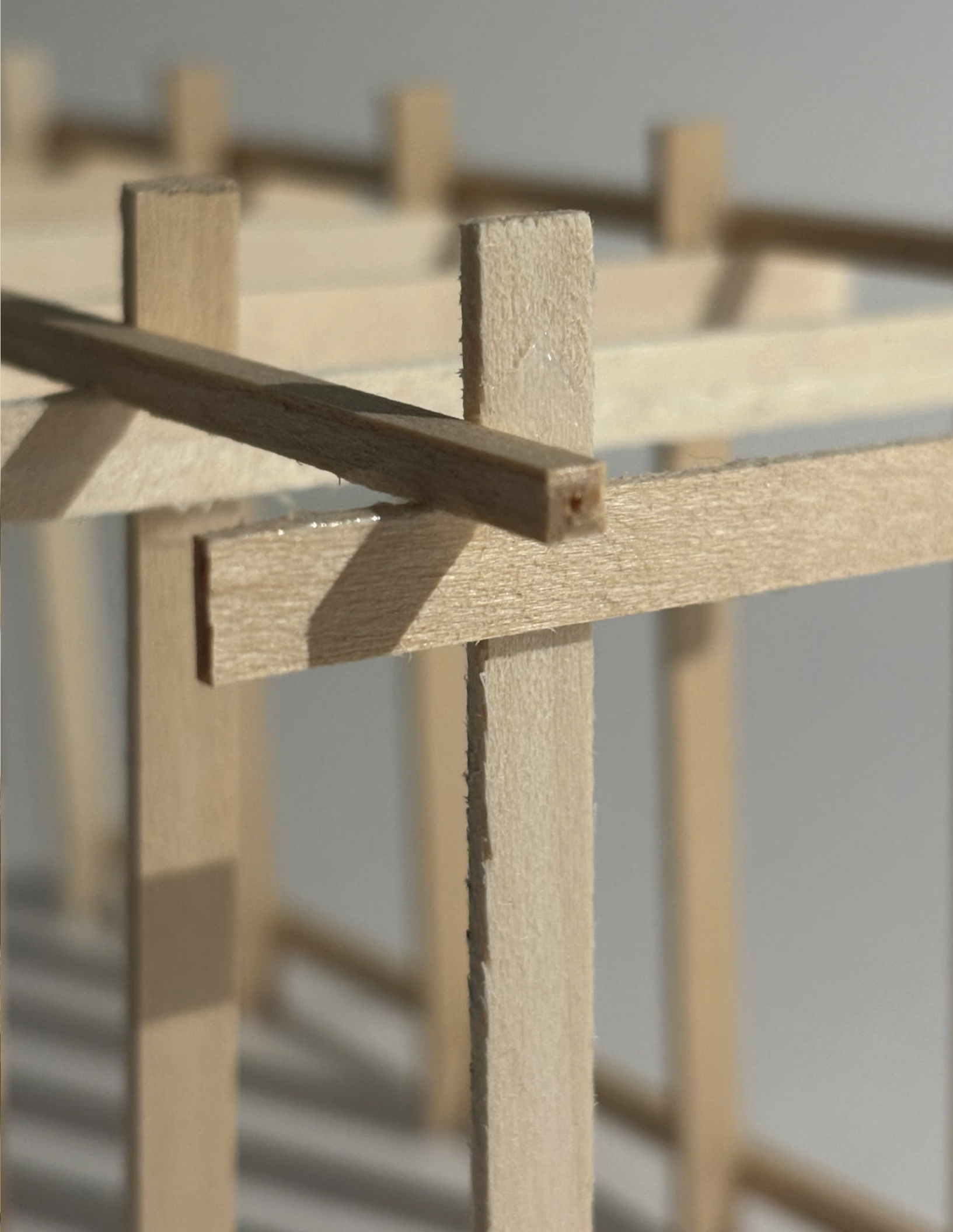

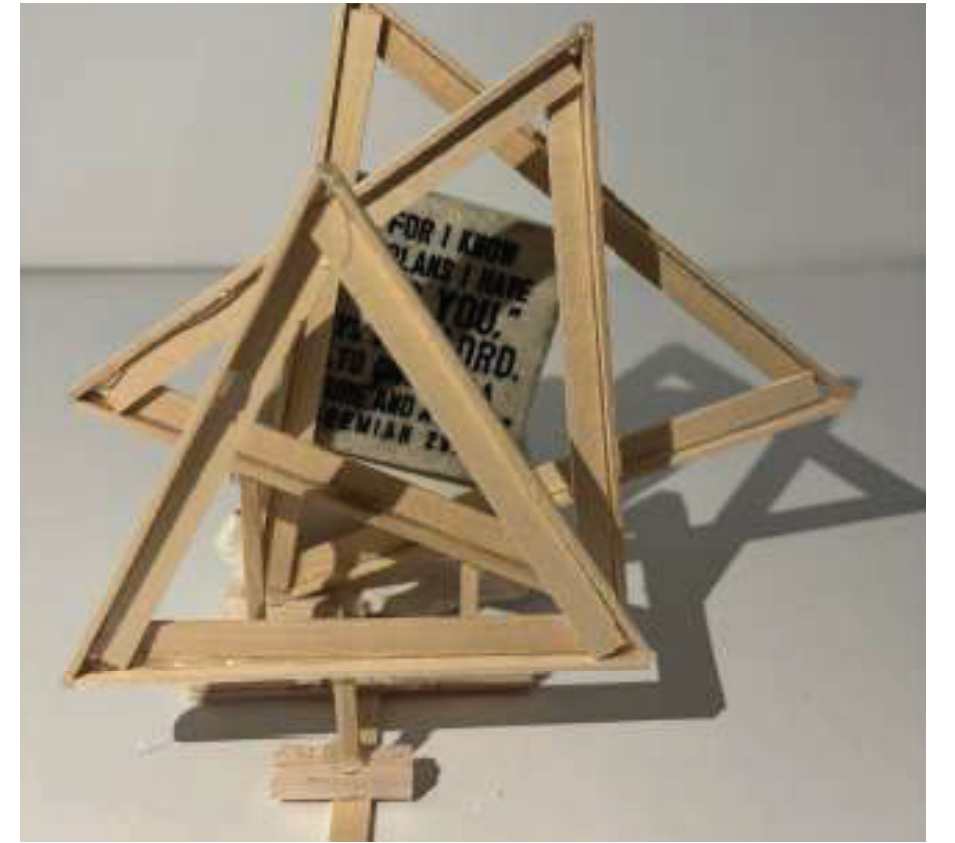
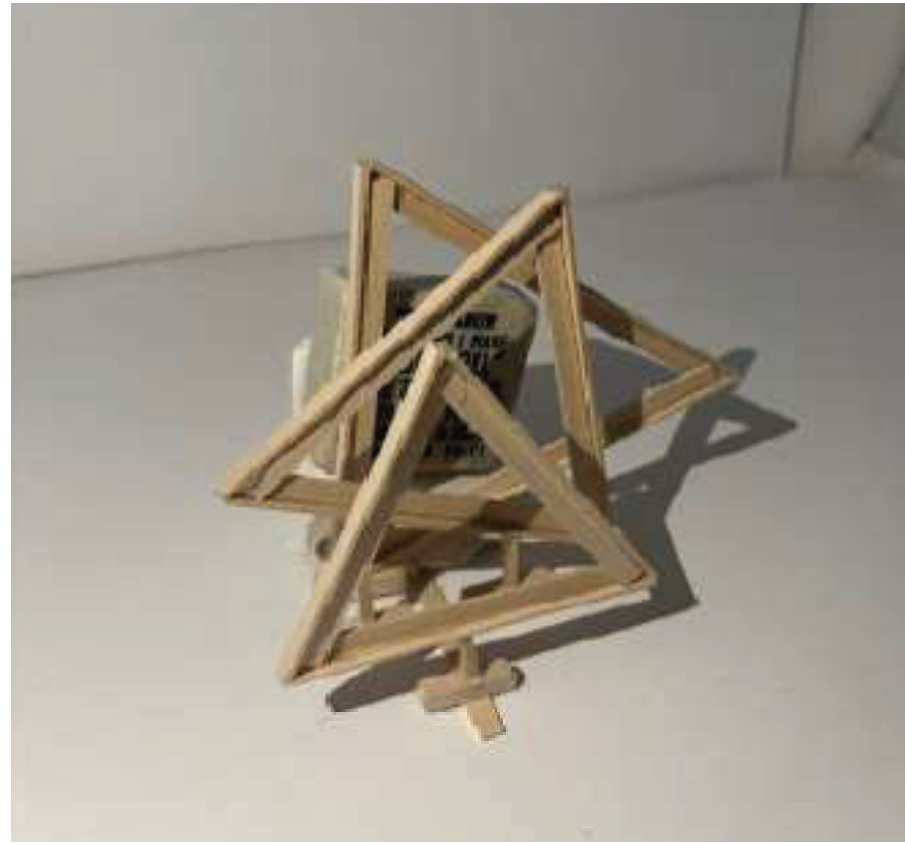
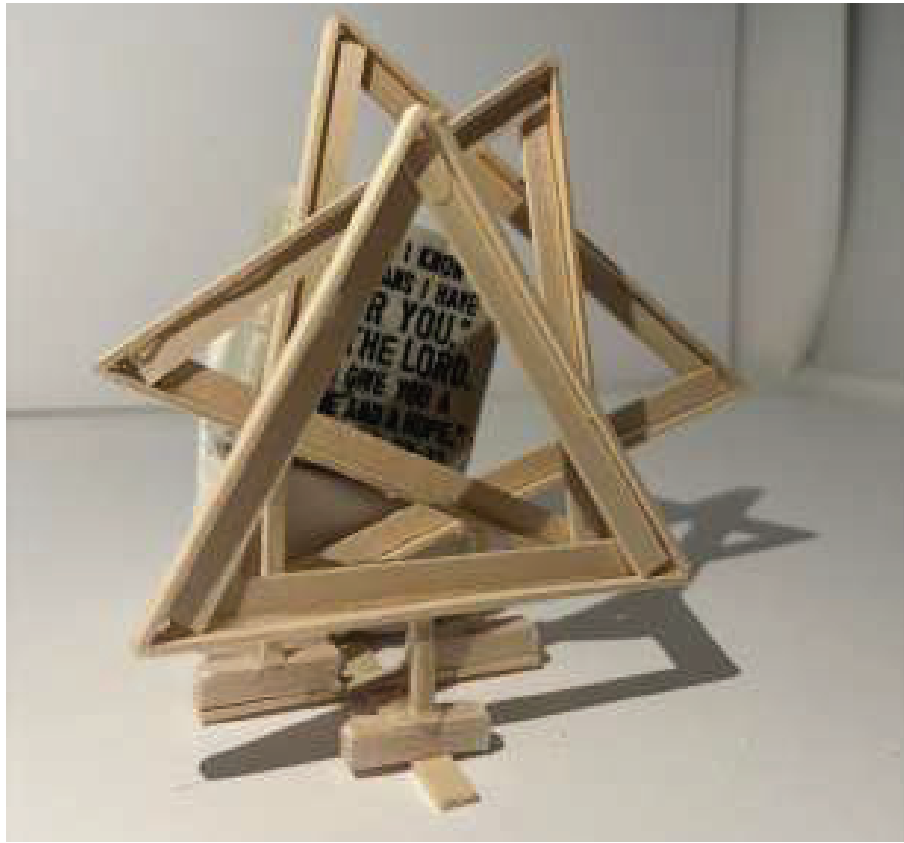

For project 4, I focused on an object and built a space around it. The object I chose was a stone with a quote from the Bible that ties me personally to my religion. My object is being held up by plaster to symbolize that my faith uplifts me and keeps me motivated. The three triangular sticks draw your eyes through them to look at the stone while simultaneously making a shape similar to the Holy Trinity.

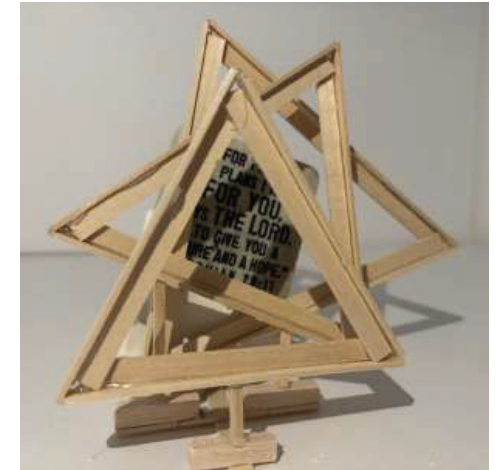

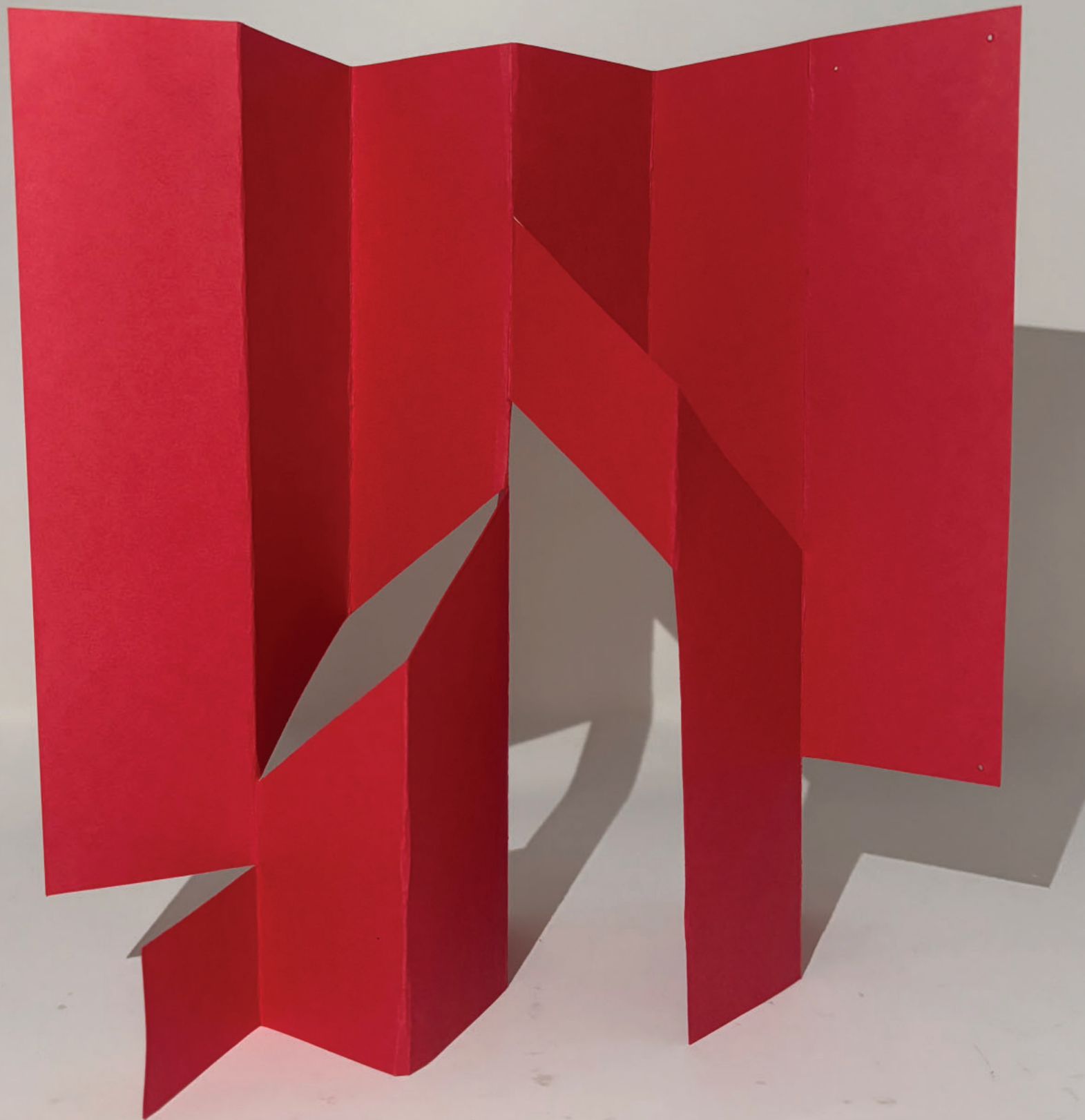

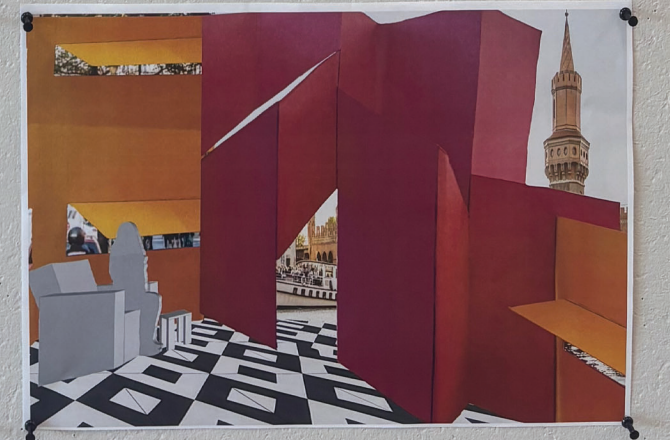
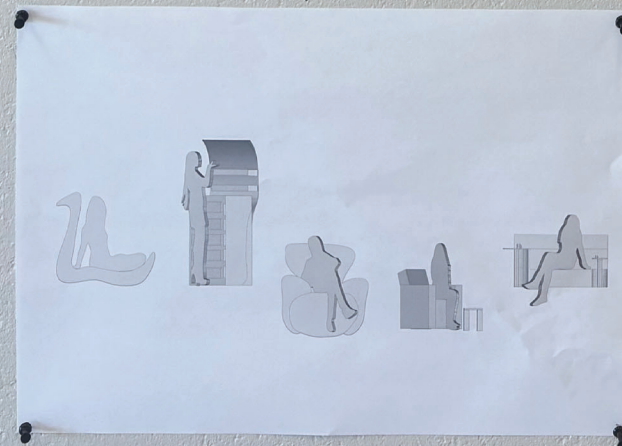
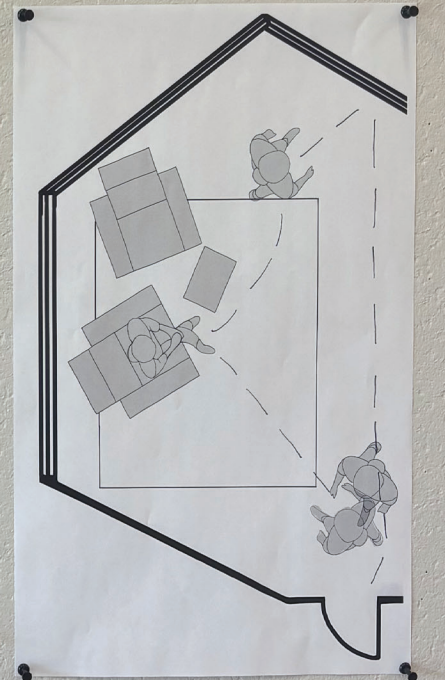
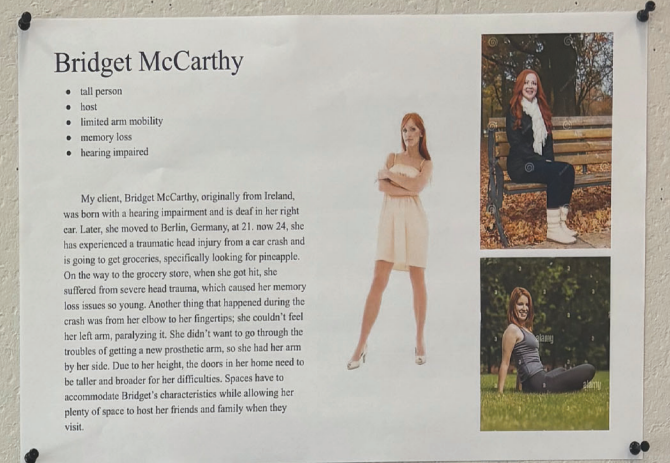
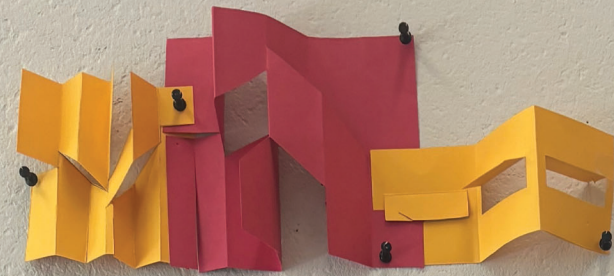
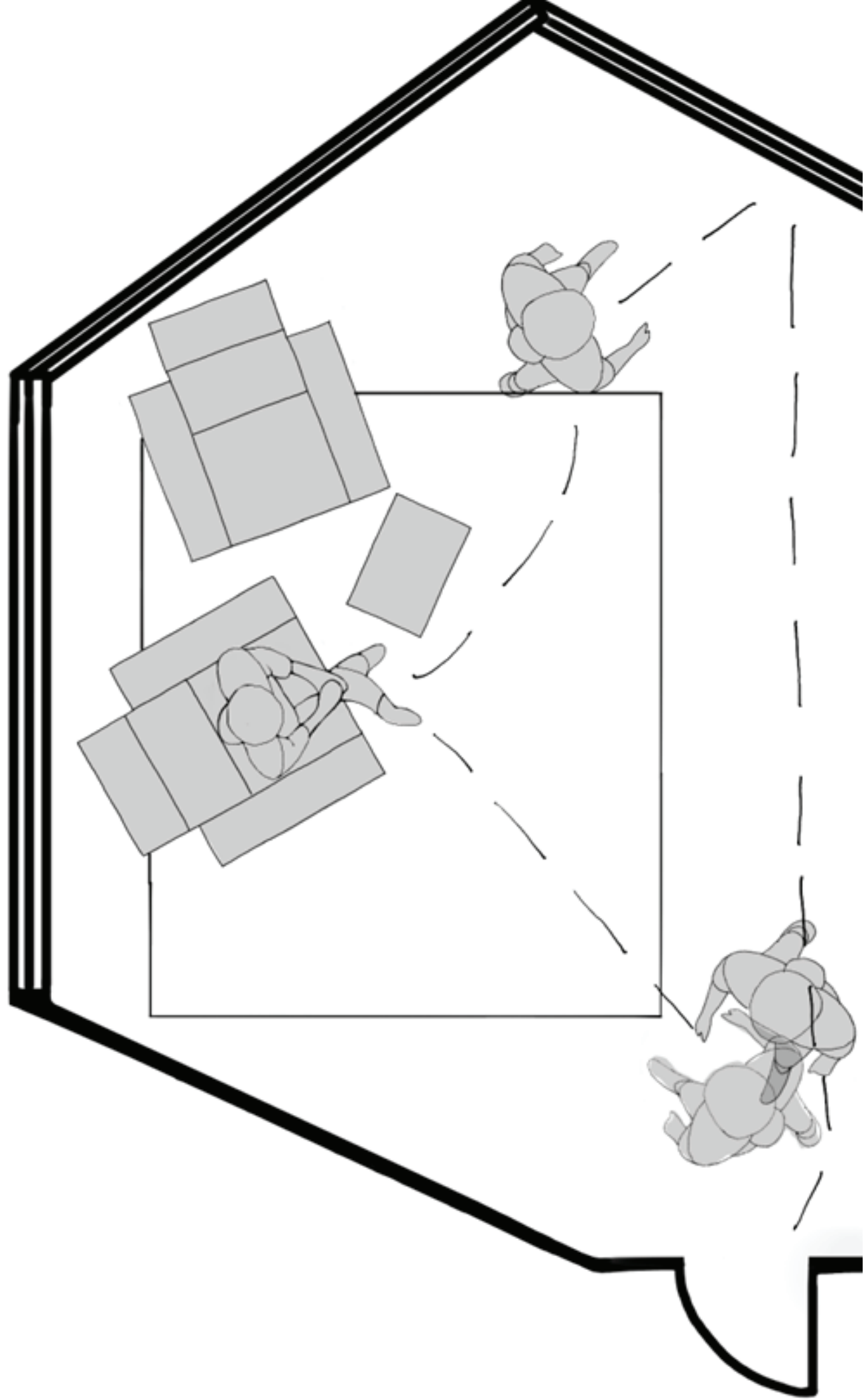

Bridget McCarthy

- tall person
- host
- limited arm mobility
- memory loss
- hearing impaired

My client, Bridget McCarthy, originally from Ireland, was born with a hearing impairment and is deaf in her right ear. Later, she moved to Berlin, Germany, at 21. now 24, she has experienced a traumatic head injury from a car crash and is going to get groceries, specifically looking for pineapple. On the way to the grocery store, when she got hit, she suffered from severe head trauma, which caused her memory loss issues so young. Another thing that happened during the crash was from her elbow to her fingertips; she couldn't feel her left arm, paralyzing it. She didn't want to go through the troubles of getting a new prosthetic arm, so she had her arm by her side. Due to her height, the doors in her home need to be taller and broader for her difficulties. Spaces have to accommodate Bridget's characteristics while allowing her plenty of space to host her friends and family when they visit.



For project 5, I started by exploring a part of Berlin, Germany, and making paper folds based on things I could relate to. We used Rhino to create an interactive chair or furnishing for them to use in the space. I then started to create a space that could accommodate my clientele with specific needs. I drew section plans and created montages to visualize better and explore how to make the environment my person needed.

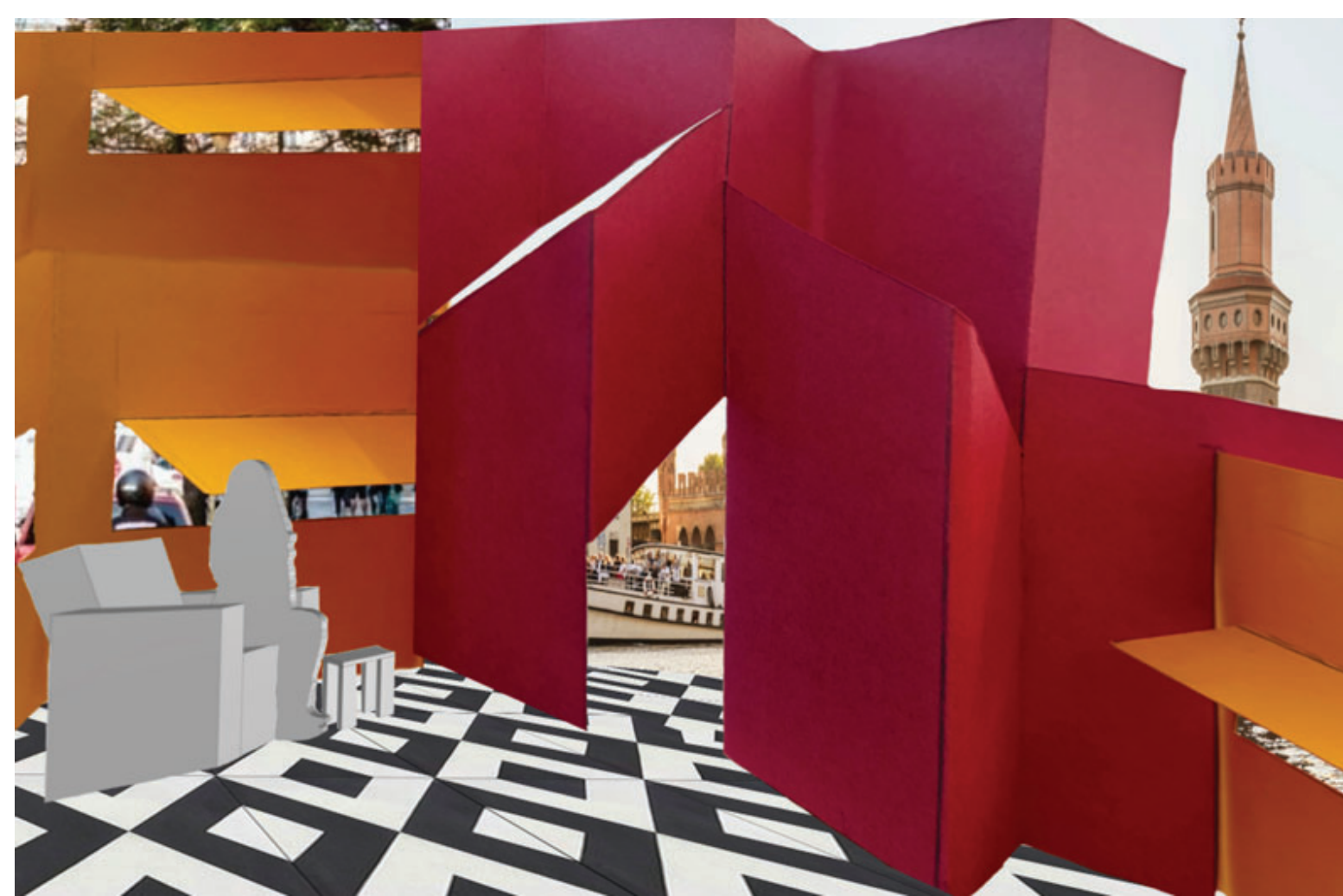

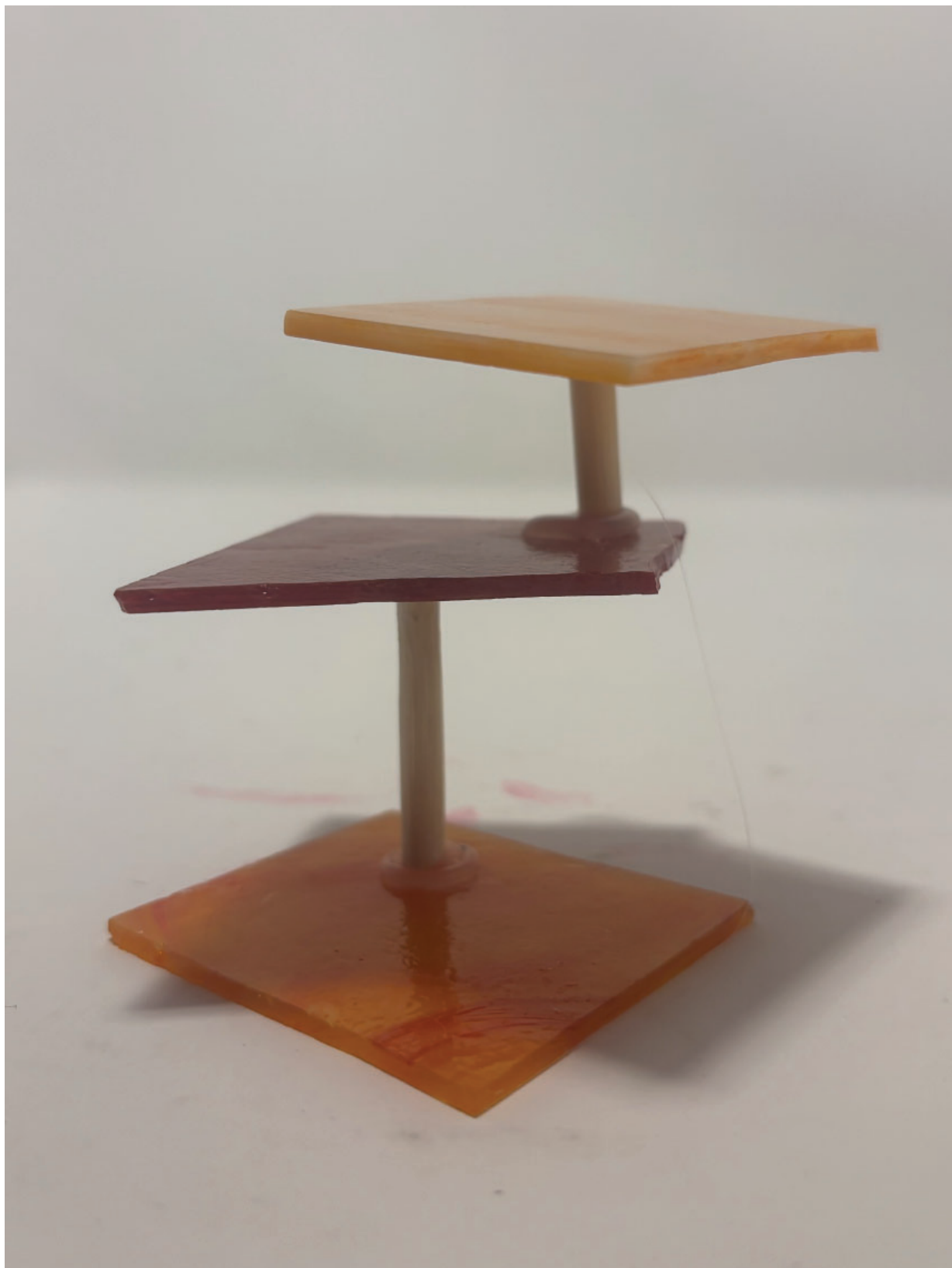

JENGA 1.0 Clasrrom space models



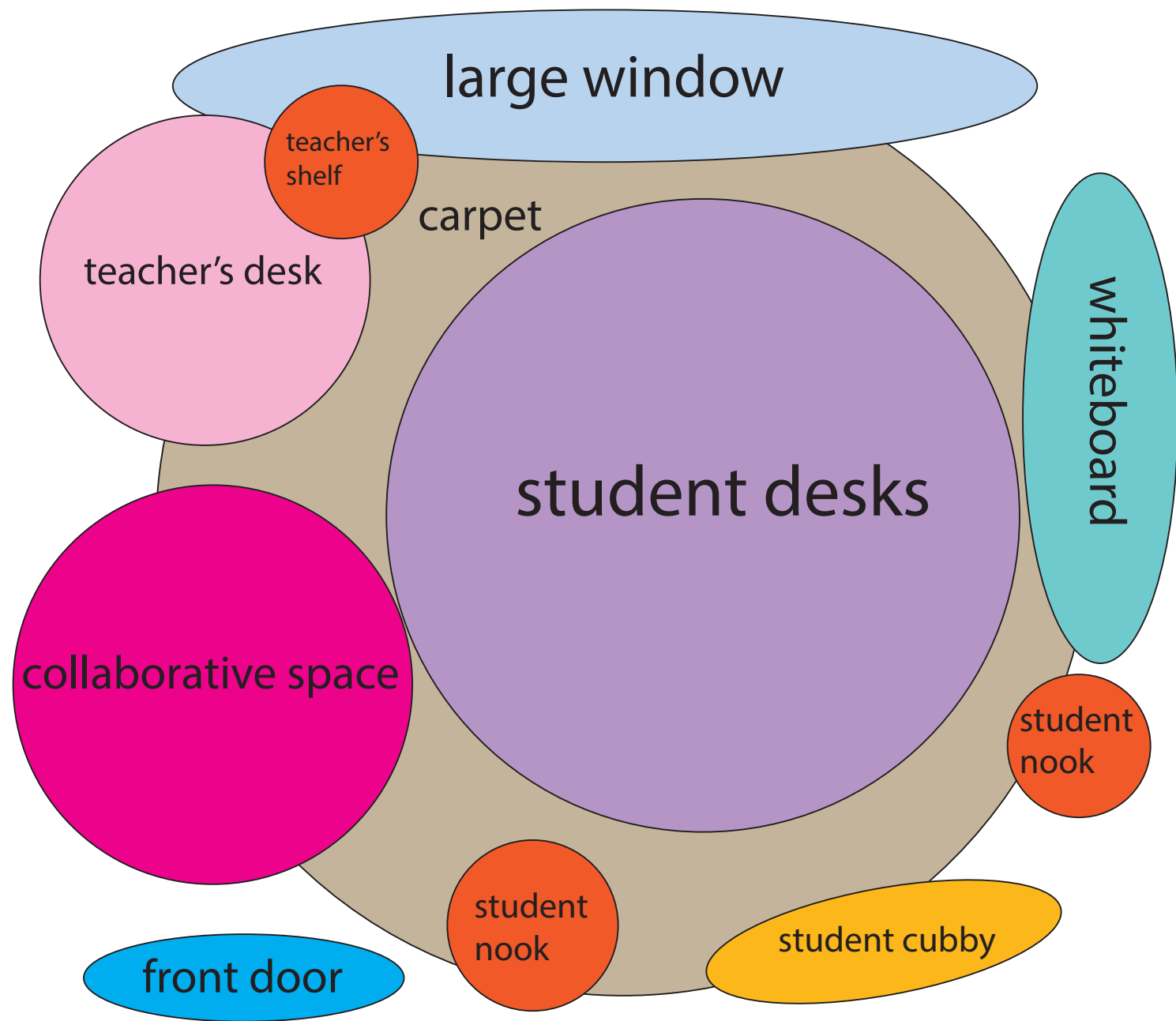

JENGA 1.0 Bubble Diagram Class-room space - Morocco



Communications Stair model





JENGA 2.0 Media Cart model and outdoor space model





As an interior design student, I have developed a passion for the environments we inhabit, encompassing both our indoor and outdoor spaces. The design and functionality of the spaces I work with play a crucial role in shaping our emotional well-being, productivity, and overall quality of life. Thoughtfully designed environments can foster creativity, enhance comfort, and improve our daily experiences. I am eager to contribute to this field by creating spaces that are not only aesthetically pleasing but also tailored to meet the needs and preferences of the individuals who occupy them. My goal is to design environments that people genuinely love and where they feel inspired and at ease. As an interior design student, I have a deep passion for the environments we inhabit, both indoors and outdoors. These spaces influence our emotional well-being and our potential for success in everyday life. I am excited about the opportunity to create spaces that resonate with and inspire people.

